

## Technical information (printing and web)

Your files with templates for promotional purpose can be sent as an email attachment to [conference@ebsaweb.eu](mailto:conference@ebsaweb.eu) or on a CD-ROM to the address given below.

### Printing Material

Files with your promotional page have to be sent as PDF format.

Files with your company logo have to be sent as TIF format.

### Web-Advertisement

Files with logos for web pages have to be sent as GIF or JPG format.

## Deadlines for Sponsorship

Please note that the deadline for all printed material is **15 February 2010**.

## Cancellation Policy for Exhibitors

20% administrative costs will be charged for cancellations of registrations received before **1 February 2010**. Thereafter, 100% of the registration fee will be invoiced. Only written cancellations will be accepted (letter, fax or email).

## Conference Office

EBSA Office c/o DECHEMA e.V.

Ms. Barbara Feisst

Theodor-Heuss-Allee 25

60486 Frankfurt am Main/Germany

☎ +49 (0)69 / 7564 - 333

Fax +49 (0)69 / 7564 - 441

email: [conference@ebsaweb.eu](mailto:conference@ebsaweb.eu)

Internet: [www.ebsaweb.eu/EBSA\\_13](http://www.ebsaweb.eu/EBSA_13)

## Location

Grand Hotel Union  
Miklošičeva 1  
1000 Ljubljana/ Slovenia  
[www.gh-union.si](http://www.gh-union.si)

## How to reach Ljubljana

### Arriving by plane

"Ljubljana Jože Pučnik Airport" [www.lju-airport.si](http://www.lju-airport.si)  
Ljubljana Jože Pučnik Airport, located in Brnik near Ljubljana, is the country's main airport, located at a distance of 26 km from Ljubljana. Transportation from and to the airport can be done by taxi (20 minute ride, approx. 39 €) or by bus (the journey time is approx. 45 minutes the price for the ticket is 4,10 € one way). It serves scheduled and charter flights to and from most of European capitals

### Arriving by train

Ljubljana has good international rail connections.  
[www.slo-zeleznice.si/en](http://www.slo-zeleznice.si/en)  
The Railway Station is approx. 1 km from the Hotel.

### Arriving by car

Ljubljana is located at the crossroads of the country's most important road routes.

- from Graz (Austria): E57 or E59
- from Trieste (Italy): E61 or E70

## Accommodation

Accommodation has been reserved for the conference participants at a special discount. Reservations should be directly made by the participants before 19 March 2010.

### Grand Hotel Union

Single room	142,20 €
Double room	166,40 €

### Hotel Central (located app. 300 m from Grand Hotel Union)

Single room	123,20 €
Double room	135,20 €

The rates include breakfast and VAT.

The hotel reservation form will be available at [www.ebsaweb.eu/EBSA\\_13](http://www.ebsaweb.eu/EBSA_13) by November 2009.



## Sponsorship & Exhibition Package

13<sup>th</sup> Annual Conference  
of the European  
BioSafety Association

EBSA Workshops 21 April 2010  
EBSA Conference 22 – 23 April 2010  
Ljubljana/Slovenia

[www.ebsaweb.eu/EBSA\\_13](http://www.ebsaweb.eu/EBSA_13)

## Sponsorship & Exhibition Package for the 13<sup>th</sup> EBSA Conference 2010

Prices given are valid for corporate members.

For non-members prices will be increased by 250 €.

Please note:

The programme of the EBSA conference will be distributed to the community Europe-wide by postal mail (approx. 4.000 copies). The book of abstracts of the conference will be distributed on site to all delegates (approx. 250 – 300 people).

### A. Principal sponsorship package

**8.000 €** (one sponsor only)

Main sponsorship of the EBSA conference

- your company logo printed on the front page on conference materials (programme, book of abstracts)
- coloured advertisement page in the conference programme (size C6)
- your company logo presented on the EBSA conference website as „main sponsor“ with a link to your own website
- hand-out in conference bags
- standard exhibition space (6 sqm) for full 2 days in primary position
- free conference tickets for 2 delegates

### B. Workshop sponsorship packages

**2.000 €** (topics: [www.ebsaweb.eu/EBSA\\_13](http://www.ebsaweb.eu/EBSA_13))

- your company logo printed on the front page on workshop materials (hand-outs for each workshop)
- your company logo presented on the EBSA workshop website and a link to your own website
- free conference ticket for 1 delegate

### C. Sponsorship of Reception

**3.000 €** (one sponsor only)

- reference in printed programme, book of abstracts and on website of the conference
- company reference at the welcome reception (provided by sponsor)

### D. Sponsorship of Conference Dinner

**4.000 €** (one sponsor only)

- reference in printed programme, book of abstracts and on website of the conference
- company reference at the conference dinner (provided by sponsor)

### E. Standard exhibition space

**1.700 €**

- exhibition space (6 sqm) for 2 days
- equipment: 1 table, 1 chair
- free conference ticket for 1 delegate
- acknowledgement in programme, book of abstracts and website of the conference

Additional exhibition space will be charged with 250 € per sqm

### F. Table top

**1.200 €**

- exhibition space (3 sqm) for 2 days
- equipment: 1 table, 1 chair
- free conference ticket for 1 delegate
- acknowledgement in programme, book of abstracts and website of the conference

### G. Sponsorship of conference bags

**2.750 €** (one sponsor only)

- your logo and company name on the conference bag

### H. Hand-out in conference bag

**500 €**

- hand-out provided by sponsor

### I. Promotional pages

- 1/1 inside page print of your advertisement
  - a. conference programme (colour, size C6)  
**1.000 €**
  - b. book of abstracts (black-and-white, size A4)  
**1.000 €**
- 1/1 last cover page print of your advertisement
  - a. conference programme (colour, size C6)  
**2.000 €** (one sponsor only)
  - b. book of abstracts (colour, size A4)  
**2.000 €** (one sponsor only)

If you have inquiries or interests to exhibit or to take up sponsorship, please fill out the attached registration form.

For special arrangements please contact the EBSA Conference Office.

We look forward to working with you.

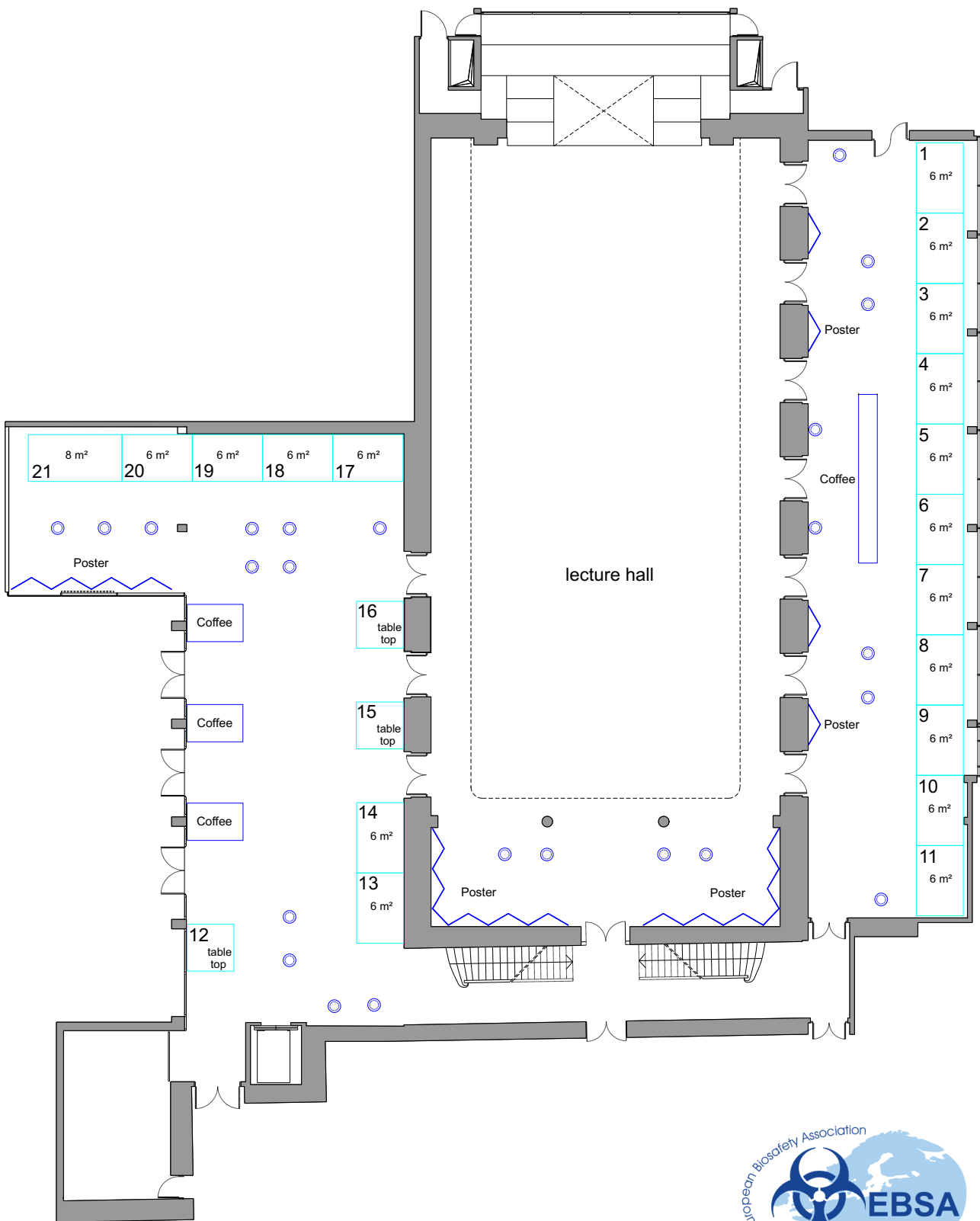

EBSA 22 - 23 April 2010

# REGISTRATION FORM SPONSORSHIP & EXHIBITION



## 13<sup>th</sup> Annual Conference of the European BioSafety Association 22 – 23 April 2010, Ljubljana/Slovenia

Please complete this form with a typewriter or in block letters and keep one copy with your files and return to:  
EBSA Office c/o DECHEMA e.V., Ms. Barbara Feißt, P.O. Box 15 01 04, 60061 Frankfurt am Main/Germany  
**Fax: +49 (0)69 / 7564-441**

Company: \_\_\_\_\_

Department: \_\_\_\_\_

Person to contact: \_\_\_\_\_

Street: \_\_\_\_\_ P.O. Box: \_\_\_\_\_

Postal Code/City: \_\_\_\_\_ Country: \_\_\_\_\_

Phone: \_\_\_\_\_ Telefax: \_\_\_\_\_

E-Mail: \_\_\_\_\_ URL: \_\_\_\_\_

<input type="radio"/>	<b>A</b>	<b>Principal sponsorship package</b>	one sponsor only	8.000 €
<input type="radio"/>	<b>B</b>	<b>Workshop sponsorship packages</b>		2.000 €
<input type="radio"/>	<b>C</b>	<b>Sponsorship of Reception</b>	one sponsor only	3.000 €
<input type="radio"/>	<b>D</b>	<b>Sponsorship of Conference Dinner</b>	one sponsor only	4.000 €
<input type="radio"/>	<b>E</b>	<b>Standard exhibition space</b>	6 sqm	1.700 €
<input type="radio"/>	<b>F</b>	<b>Table top</b>	3 sqm	1.200 €
<input type="radio"/>	<b>G</b>	<b>Sponsorship of conference bags</b>	one sponsor only	2.750 €
<input type="radio"/>	<b>H</b>	<b>Hand-out in conference bag</b>		500 €
<input type="radio"/>	<b>I</b>	<b>Promotional pages 1/1 inside</b>		
<input type="radio"/>		<b>a. conference programme (colour)</b>		1.000 €
<input type="radio"/>		<b>b. book of abstracts (black-and-white)</b>		1.000 €
<input type="radio"/>	<b>I</b>	<b>Promotional pages 1/1 last cover</b>		
<input type="radio"/>		<b>a. conference programme (colour)</b>	one sponsor only	2.000 €
<input type="radio"/>		<b>b. book of abstracts (colour)</b>	one sponsor only	2.000 €
<input type="radio"/>		<b>Corporate Member</b>		0 €
<input type="radio"/>		<b>Non Corporate Member</b>		250 €
<b>Total Amount:</b>				_____ €

We shall pay total amount on receipt of the invoice:

- by bank transfer (you will receive all information with the invoice)  
 by credit card (please indicate accordingly)  
 MasterCard       VISA       AMEX

Card No: \_\_\_\_\_ Valid until: \_\_\_ / \_\_\_

Card Verification Value<sup>1)</sup> \_\_\_\_\_

Place, Date \_\_\_\_\_

Company stamp and signature \_\_\_\_\_

1) These are 3 digits (AmEx: 4 digits) in the sign field on the backside of your creditcard at the end of the card number (AmEx: in front of your creditcard above the card number)